

VES3581Z

Price: 400,000€



-  **Land**
-  **North West Murcia**
-  **3 Bedrooms**
-  **3 Bathrooms**
-  **130m² Build Size**
-  **5000m² Plot Size**
-  **Pool: Yes**

Ref: NWM-CAL-NBBESPOKE Exclusive NEW Architect designed BESPOKE Villas with choice of individual plots with lovely country & mountain views yet close to amenities. from €400,000 EurosLocation: Choice of Individual plots with Great Views in NW MurciaPrice: To suit most budgetsSummaryDetached bespoke villa (110m2-200) Plot 525m2 or 1,000m2 (Urbanisations) or 5,000m2 (rural fully legal) Private swimming pool optional extra 3/4-Double bedrooms all with fitted wardrobes 2/3-Bathrooms Fully fitted kitchen Spacious lounge /dining room Fully Double Glazed Windows to meet the latest quality standards Hot & Cold Air-conditioning inst...

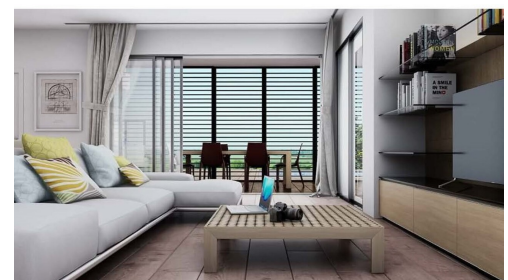
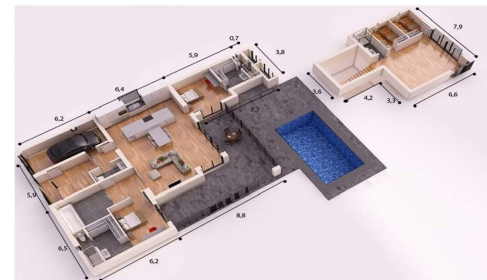

lled Garage (Optional extra) Lovely country & mountain views Quality build with good specifications Terraces open and covered We have long experience of working with architects & small quality builders We have individual plots available with great views yet close to the amenities of towns and villages (most within walking distance) Build time is 10-12 months with architect supervision

Build Option: One of our architect has adapted the acclaimed Passivhaus Building Concept especially for the Mediterranean so that the whole house has an A rating for energy efficiency without increasing the building costs. His buildings provide a high level of occupant comfort while using very little energy for heating or cooling. They are built with meticulous attention to detail and rigorous design and construction according to principles developed by the Passivhaus Institute in Germany, and can be certified through an exacting assurance process. The Passivhouse building concept is the gold standard for energy efficient and refers to buildings created to rigorous energy efficient design standards so that they maintain an almost constant temperature. ... There are 5 principles of a passive house? Fundamental to the energy efficiency of these buildings, the following five principles are central to Passive House design and construction: 1) superinsulated envelopes, 2) airtight construction, 3) high-performance glazing, 4) thermal-bridge-free detailing, and 5) heat recovery ventilation.